

# PD<sup>®</sup> 60 PIXEL DOT

## User's Manual & Installation Guide

### Index

V.1.2

- |   |   |   |                                     |
|---|---|---|-------------------------------------|
| 1 | Cover & Index                             | 6 | Installation Instruction            |
| 2 | Safety Information<br>Warranty<br>Marking | 7 | Ordering Information<br>Accessories |
| 3 | Explanation<br>Details                    | 8 | Technical Drawing                   |
| 4 | Block Diagram                             | 9 | Back Cover                          |
| 5 | Connection Diagram                        |   |                                     |

Congratulations on choosing a HERA product!  
We thank you for your custom.

Please note that this product, as all the others in the rich HERA range, has been designed and made with total quality to ensure excellent performance and best meet your expectations and requirements. Carefully read this instruction manual in its entirety and keep it safe for future reference. It is essential to know the information and comply with the instructions given in this manual to ensure the fitting is installed, used and serviced correctly and safely. HERA disclaims all liability for damage to the fitting or to other property or persons deriving from installation, use and maintenance that have not been carried out in conformity with this instruction manual, which must always accompany the fitting. HERA reserves the right to modify the characteristics stated in this instruction manual at any time and without prior notice.

## Safety Information

Caution – unplug the power supply from the main power before connecting any cables as this can damage the products.

Caution – avoid looking directly into the led light source at close range for your own safety.

Any people installing this product should comply with local standards and regulations and must be qualified for the handling of electrical equipment.

- Do not attempt to install or use the product until installation instructions and safety labels are fully understood. This product is designed for indoor and outdoor usage.
- Ensure product operates within the specified temperature range.
- Do not attempt to open the product.
- Do not use the product if the power cables are damaged.
- Only use product for specified voltage.
- Always maintain connection to ensure waterproofing.
- If the product has been subjected to drastic temperature variances, for example, following transportation, do not connect the fixture until it has reached room temperature, as moisture condensation may cause electric shock and product damages.
- When installing the products and system power supplies, please ensure they will not be exposed to moisture and extreme heat (and direct sunlight for outdoor products). Besides, keep a clean operating environment for the fixtures and system power supplies.
- Please study this Installation Guide thoughly and check the latest Technical Specification Sheets available from the our website [www.heraled.com](http://www.heraled.com) before setup.
- Any non-compliance of the Installation Guide will void the Hera warranty.

## Warranty

Hera warrants the products for a period of three (3) years from date of purchase, provided that the purchased items are used under the conditions stated in this user manual.

## Marking



Explanation

Hera PD®60 is a point pixel fixture with direct view type. It has 18 pieces 3 in1 chip leds at high brightness. It is visible at sunlight. Maximum 32 devices can be connected to each other. It has 3 Channel DMX. Channel 1: 0-255 Red, Channel 2: 0-255 Green, Channel 3: 0-255 Blue. It is in IP67 protection class. The connection is made with waterproof 5 Pin IP67 Push-Lock type connector. It provides special video solutions with maximum brightness. It offers customizable solutions pixel mapping with DMX 512 protocol. It can be addressed in batch with RDM Protocol. It has been designed to be used in the facade, building and stage illumination. It operates with 48V voltage and applicable without voltage loss. It resistance to UV lights. It is made of aluminum body resistant against the challenging weather conditions. It is recommended to use with Power Pack® 320 and Power Pack® 2500 as a feeding unit.

- High productivity and long life span
- Long distance applicability between DMX communication and pixel range
- Addressing with Remote Device Management Protocol
- Maximum 32 pixel per line
- Safe use in interior and external environment with IP67 protection

Details

Light Source	: 18 Pcs. Nichia NSSM032A
Lifetime	: 50.000 Hours
Input	: 48VDC 5-Pin IP67 Waterproof Connector (Power + DMX)
Current Consumption	: 100 mA
Power Consumption	: 5 Watt
Maximum in Chain	: 32 pcs. (With 1,5 meter cable)
Luminous Intensity	: Luminous intensity, calibrated mode: 45 cd Total output, calibrated mode: 135 lm *Preliminary data, figures are approximate.
Control and Programming	DMX 512
DMX Channels	Ch1: Red 0 - 255 Ch2: Green 0 - 255 Ch3: Blue 0 - 255 Color Temperature Control: 2.000 - 10.000 K Continuous Mixing
DMX Address Settings	: RDM (Group of Remote Addressable Systems)
Housing	: Die-Cast Aluminium Body. Die-Cast Polycarbonate with UV Stabilizer Cover
Screw and Mounting Accessories	: 304L Stainless Steel
Temperature	: Operating : -40°C - 50°C - (-40° - 122° F) Storage : -40°C - 85°C - (-40°C - 185° F)
Dimensions (H x W x D)	: 73x90x73 mm ( 2,87x3,54x2,87 in)
Weight	: 0.265 kg (0,584 lb)
Certification	: EU safety: EN 60950-1, EN 60950-22 EU EMC: EN 55022, EN 55024, EN 61000-3-2, EN 61000-3-3 US safety: UL 60950-1, UL 60950-22 US EMC: FCC Part 15 Class A

Block Diagram

Indoor Zone

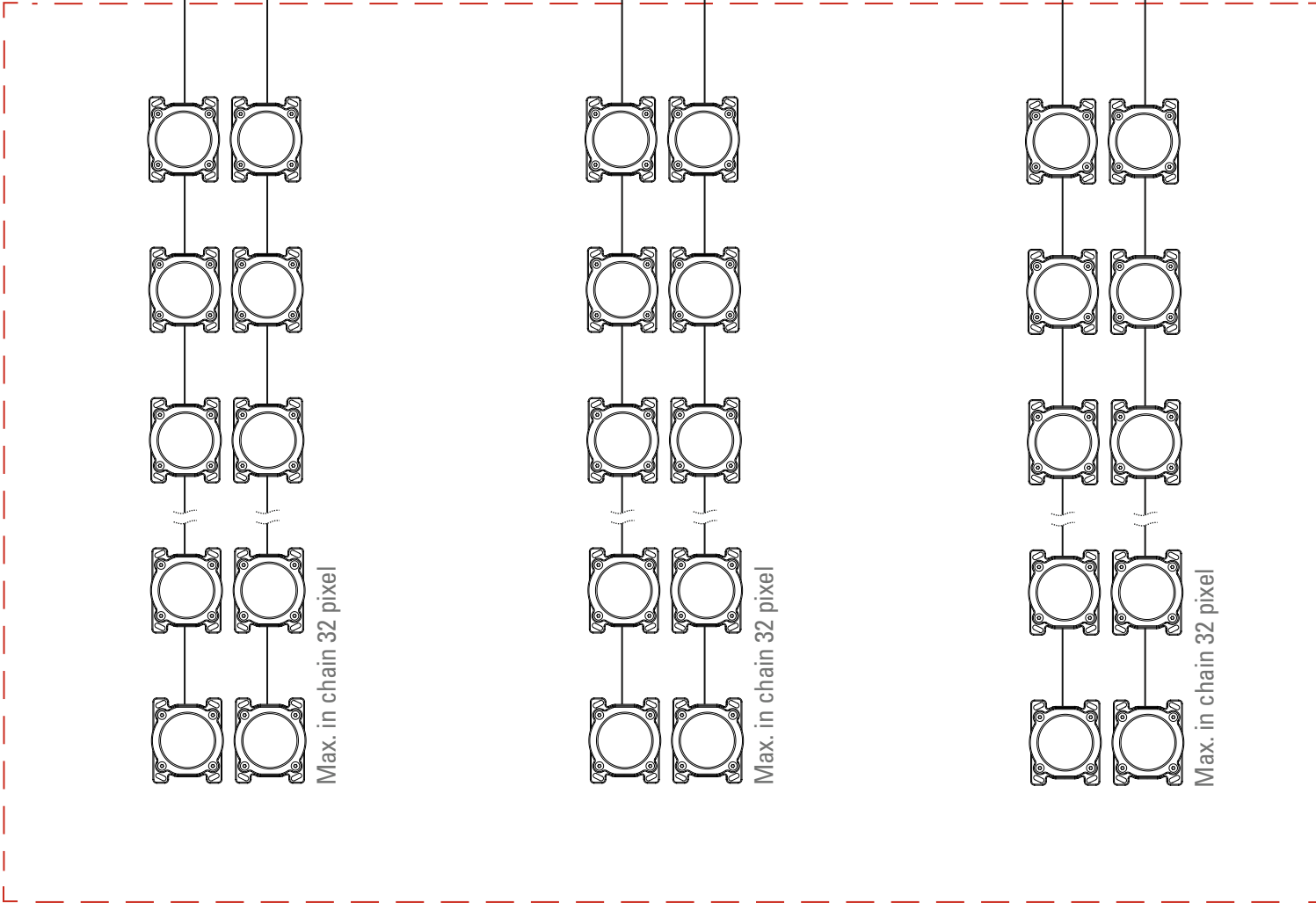
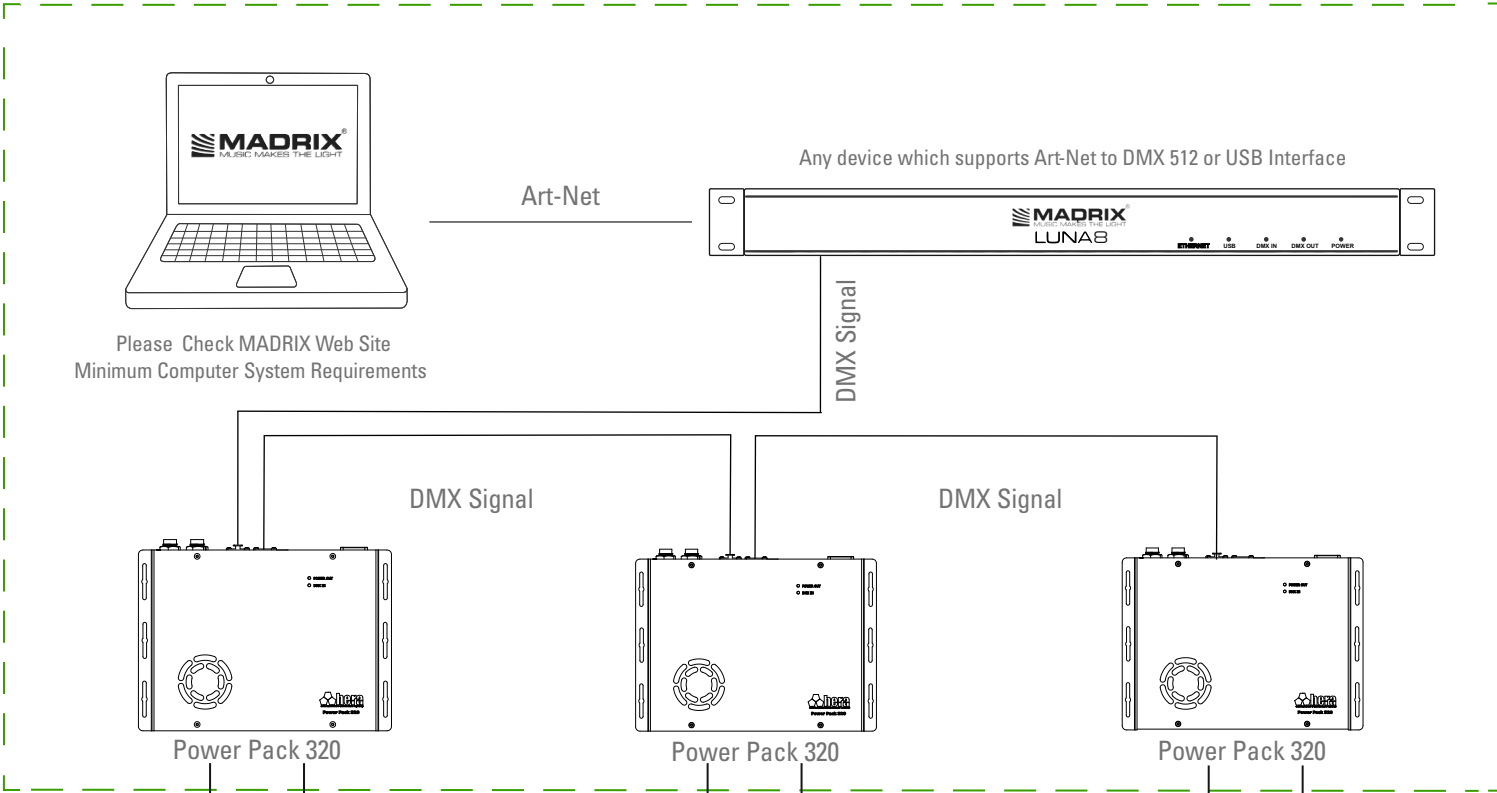

Outdoor Zone

Connection Diagram

1 Push arrow direction

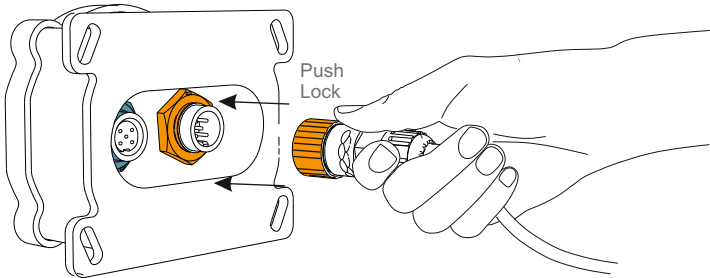

2 Turn to left and pull for removing.

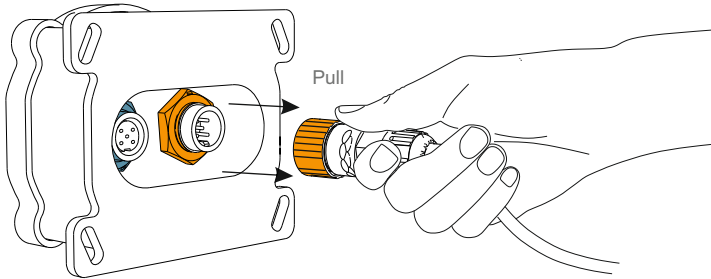
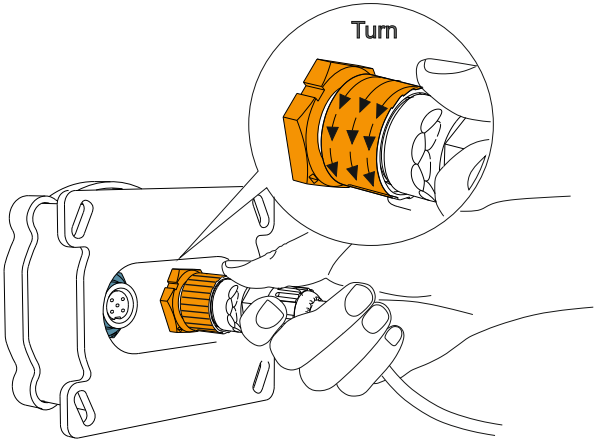

3 For instance diagram  
Max.cable length 50 meter for pixel pitch

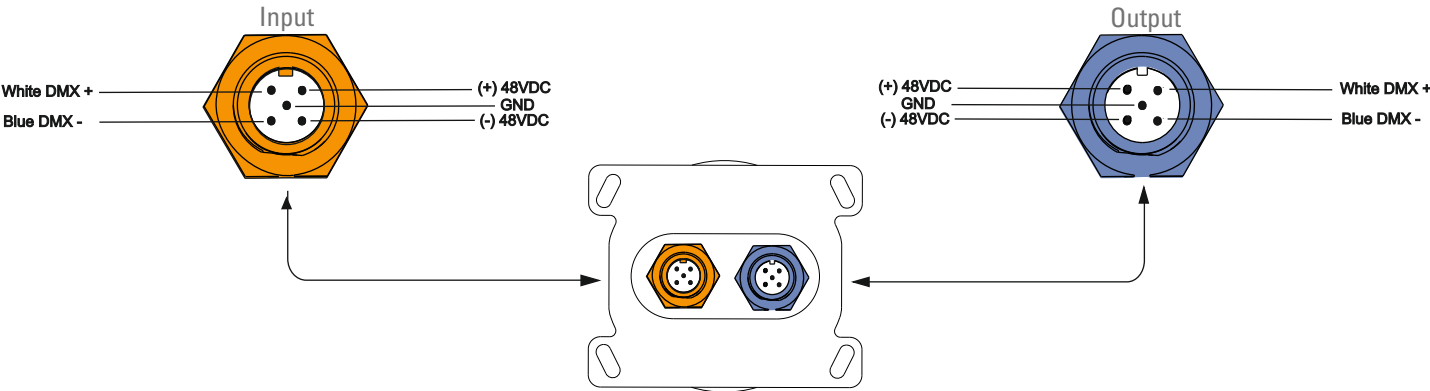
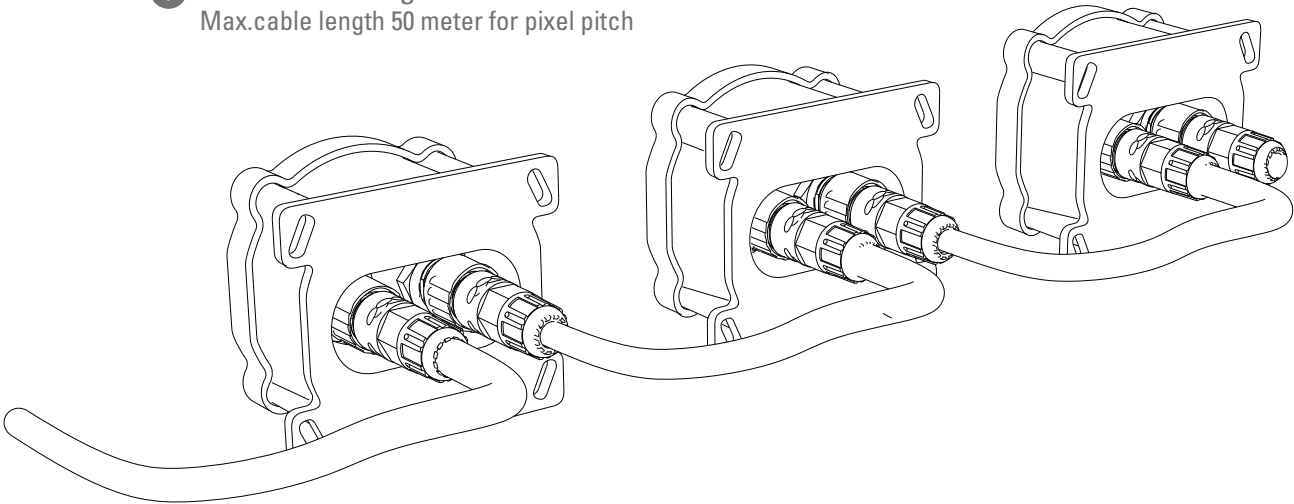

Installation Instrucion

Step	Description
1	Screwing diagram as shown at figure 1
2	Connector connection diagram as shown at figure 2
3	Finished Installation as shown at figure 3

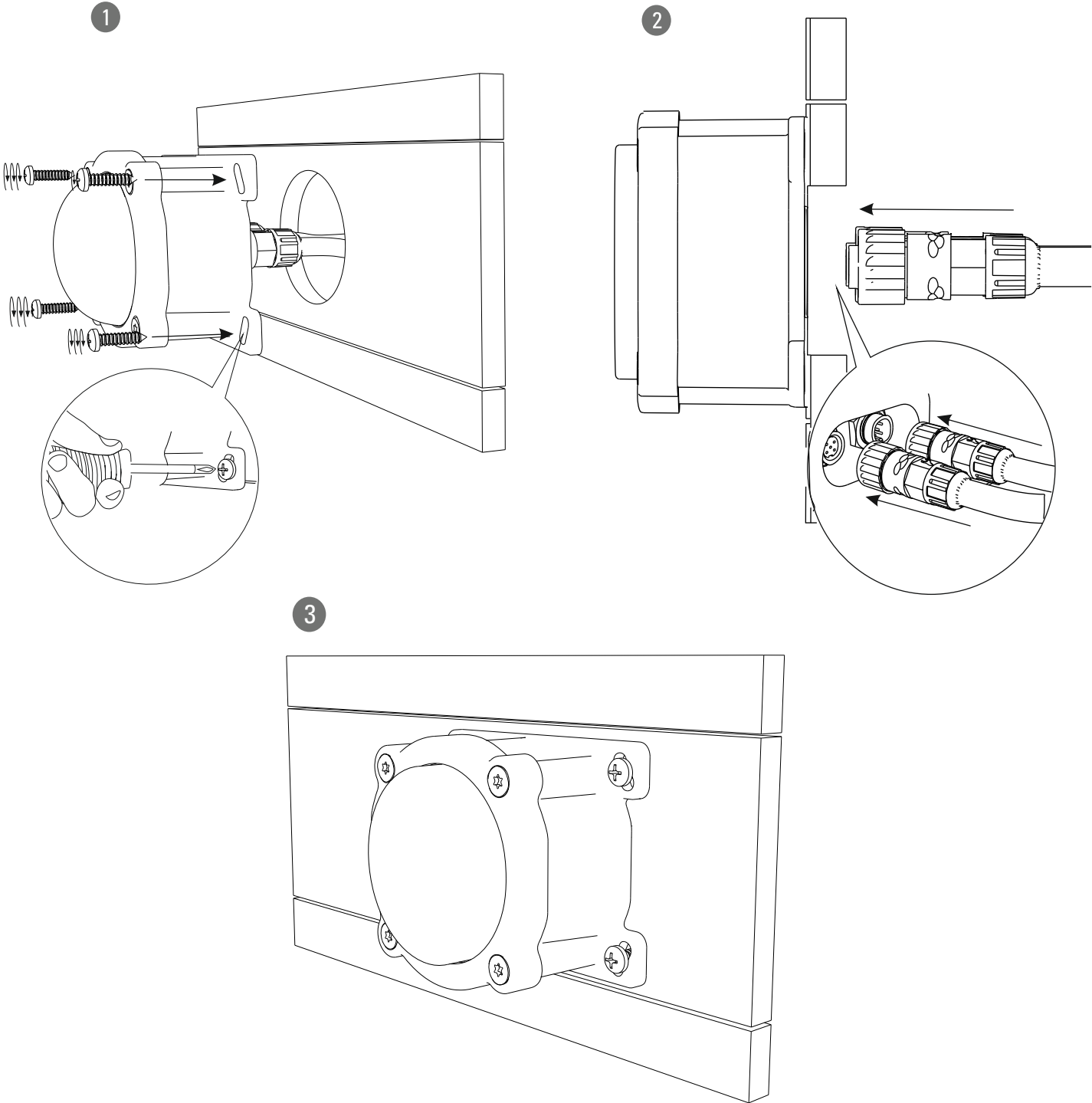

Ordering Information

PD®60RGB 3Ch. DMX Pixel Dot

P01003085

Accessories

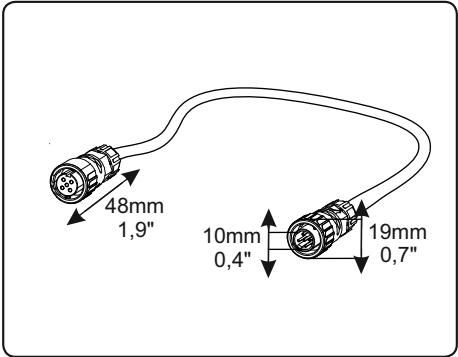

**A01001**  
75cm 5 Pin Female to Male Connectors  
Optional

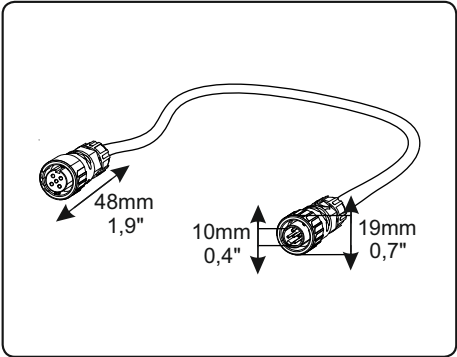

**A01002**  
100cm 5 Pin Female to Male Connectors  
Optional

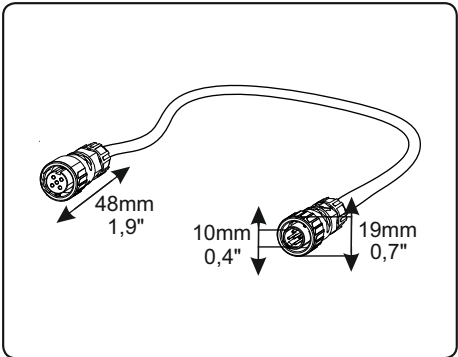

**A01003**  
120cm 5 Pin Female to Male Connectors  
Optional

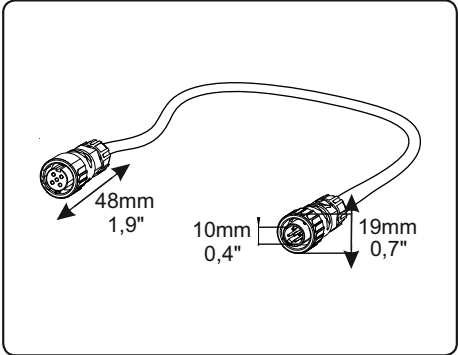

**A01004**  
150cm 5 Pin Female to Male Connectors  
Optional

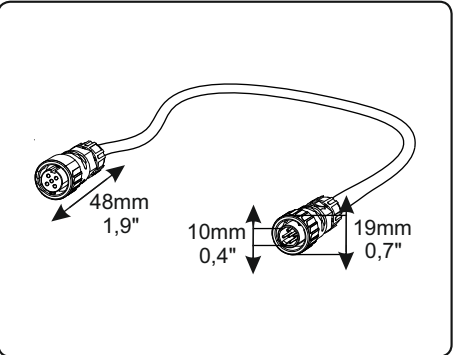

**A01005**  
200cm 5 Pin Female to Male Connectors  
Optional

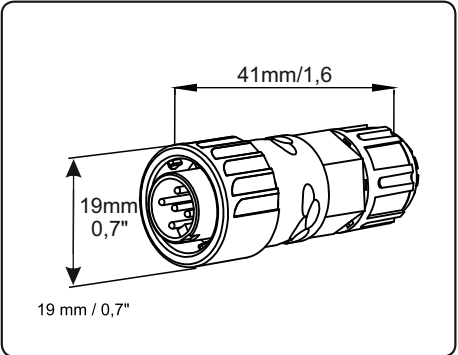

**A01020**  
A01021-5 Pole Male IP67 Push-Lock Connector  
Optional

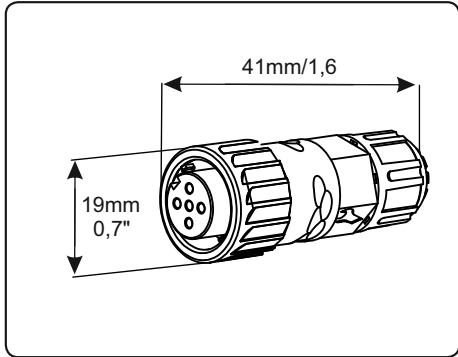

**A01021**  
A01021-5 Pole Female IP67 Push-Lock Connector  
Optional

\*Standart product codes that we provided is above. Please contact us for special orders.

Technical Drawing

